

Drum Core Power Inductors

Dimensions

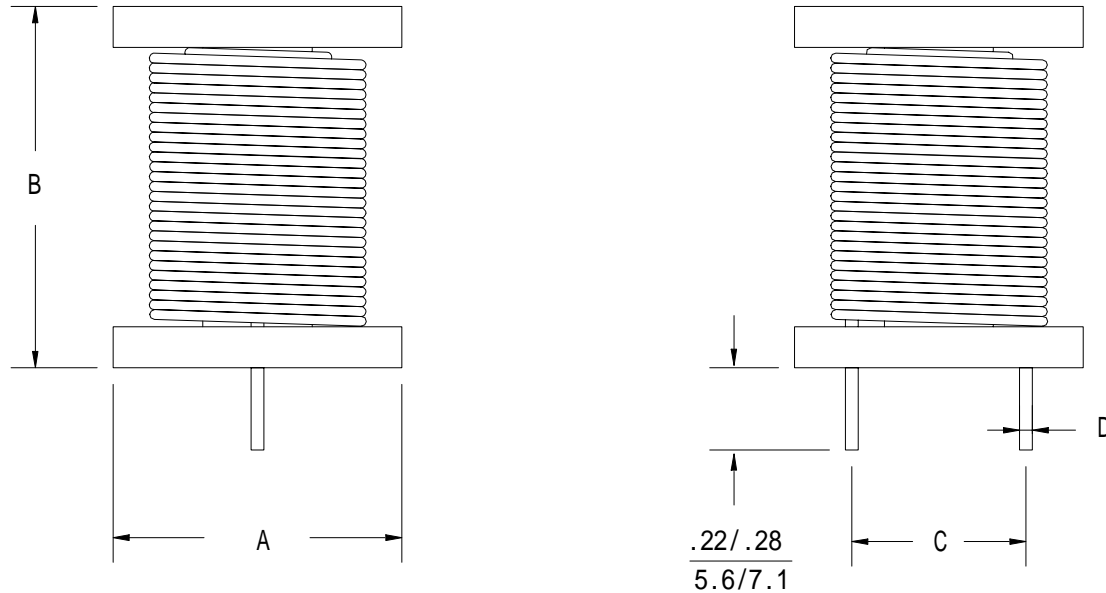

Applications

Power Amplifiers
 Filters, Power Supplies
 SCR and Triac Controls
 Speaker Crossover Networks
 RFI Suppression

Pre-Tinned Leads
 Center hole for mechanical mounting
 Test Frequency 1KHz

| Part Number | Inductance ¹ ± 10%(uH) | Isat ² (Amps) | Irms ³ (Amps) | DCR Max(Ω) | A Max | B Max | C ±.015/0.38 | D ±.004/0.10 |
|-------------|--------------------------------------|-----------------------------|-----------------------------|---------------|------------|------------|-----------------|-----------------|
| PID-D16001 | 10 | 5 | 5 | .015 | .61/15.49 | .83/21.08 | .42/10.67 | .042/1.07 |
| PID-D16002 | 10 | 10 | 10 | .010 | .61/15.49 | .83/21.08 | .50/12.70 | .054/1.37 |
| PID-D16003 | 22 | 5 | 5 | .020 | .61/15.49 | .83/21.08 | .42/10.67 | .042/1.07 |
| PID-D22001 | 22 | 10 | 10 | .015 | .86/21.84 | .83/21.08 | .58/14.73 | .054/1.37 |
| PID-D18001 | 47 | 5 | 5 | .035 | .70/17.78 | .83/21.08 | .48/12.19 | .038/0.97 |
| PID-D26001 | 47 | 10 | 10 | .020 | 1.00/25.40 | .83/21.08 | .70/17.78 | .054/1.37 |
| PID-D22002 | 100 | 3 | 3 | .080 | .84/21.34 | .83/21.08 | .58/14.73 | .031/0.79 |
| PID-D22003 | 100 | 5 | 5 | .048 | .84/21.34 | .83/21.08 | .70/17.78 | .042/1.07 |
| PID-D27001 | 100 | 10 | 10 | .032 | 1.05/26.67 | 1.10/27.94 | .88/22.35 | .054/1.37 |